

## Schurter IEC Low Current Power Inlets

230 Volt 2.5 Amp • 65°C



### Panel Screw Mount

Solder Terminals  
P/N 33-4300.0096

PCB  
P/N 33-4300.0097

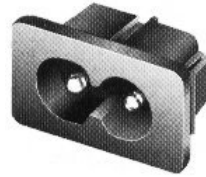

### Snap-in Mount

Solder Terminals  
P/N 33-4300.0098

PCB  
P/N 33-4300.0099

Standards: UL 498, CSA 22.2, EN 60320-1/C8, IEC 320-1/C8  
Approvals (2.5A/250V AC): SEV, VDE, SEMKO, UL, CSA, NEMKO

## Inlets

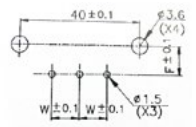
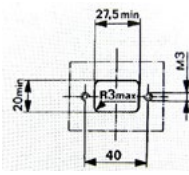
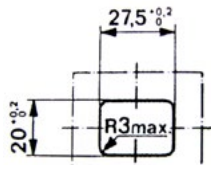

PCB Layout	
F	W
A	7.3 7.0
B	7.3 9.1
C	9.7 7.0
D	9.7 9.1

### Snap-in Mount

1/4" QC 1.5mm Panel

Part No. 33-6100.4315

or Solder Terminals

Part No. 33-6100.4115

10A SEV,VDE,SEMKO 15A UL,CSA

or Part No. 33-10R303B15

### Screw Mount

1/4" QC 1.5mm Panel

Part No. 33-6100.3300

or Solder Terminals

Part No. 33-6100.3100

10A SEV,VDE,SEMKO 15A UL,CSA

or Part No. 33-10R301B

### PCB Mount

Part No. 33-10R307A,B,C

or D VDE,SEMKO,UL,CSA

## Outlets

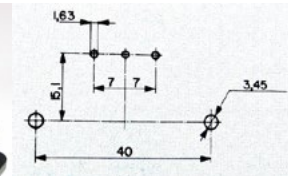
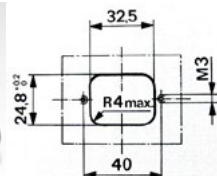
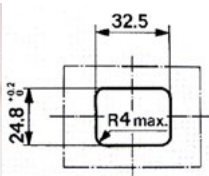

### Snap-in Mount

1/4" QC 1.5mm Panel

Part No. 33-6600.4315

or Solder terminals

Part No. 33-6600.4115

10A SEV,VDE,SEMKO

or Part No. 33-10R308B15

### Screw Mount

1/4" QC

Part No. 33-6600.3300

or Solder terminals

Part No. 33-600.3100

15A UL,CSA

or Part No. 33-10R306B

### PCB Mount

Part No. 33-4300.0251

10A SEV,VDE,SEMKO

15A UL,CSA

## Plugs

### Inlets



### Straight Plug

Part No. 33-4732.0000



### Right Angle Plug

Part No. 33-4733.0000

Pin Temp 65 deg. C – 10A 250V AC

Approvals: SEV, VDE, UL, CSA, BSI

Standards: EN 60320, IEC 320/E

### Outlets



### Straight Plug

Part No. 33-4782.0000



### Right Angle Plug

Part No. 33-4785.0000

Pin Temp 65 deg. C – 10A 250V AC

Approvals: SEV, VDE, UL, CSA, BSI

Standards: EN 60320, IEC 320/E