

Nylon Machine Screws - Pan Slot

Hi-Q Nylon screws are tough, light, durable and corrosion resistant in normal temperatures

Part Number	Thread Size	Thread Length	Part Number	Thread Size	Thread Length	Part Number	Thread Size	Thread Length
08-PNS2-04PS	M2	4	08-PNS4-12PS*	M4	12	08-PNS10-13PS	M10	13
08-PNS2-05PS	M2	5	08-PNS4-16PS*	M4	16	08-PNS10-30PS	M10	30
08-PNS2-06PS	M2	6	08-PNS4-20PS	M4	20	08-PNS10-50PS	M10	50
08-PNS2-08PS	M2	8	08-PNS4-25PS	M4	25			
08-PNS2-10PS	M2	10	08-PNS4-30PS	M4	30			
08-PNS2-20PS	M2	20	08-PNS4-35PS	M4	35			
08-PNS2-25PS	M2	25	08-PNS4-40PS	M4	40			
08-PNS2.5-04PS	M2.5	4	08-PNS5-08PS*	M5	8			
08-PNS2.5-05PS	M2.5	5	08-PNS5-10PS*	M5	10			
08-PNS2.5-06PS	M2.5	6	08-PNS5-12PS*	M5	12			
08-PNS2.5-10PS	M2.5	10	08-PNS5-16PS*	M5	16			
08-PNS2.5-12PS	M2.5	12	08-PNS5-20PS*	M5	20			
08-PNS2.5-20PS	M2.5	20	08-PNS5-25PS*	M5	25			
08-PNS3-05PS	M3	5	08-PNS5-30PS	M5	30			
08-PNS3-06PS*	M3	6	08-PNS5-40PS	M5	40			
08-PNS3-10PS	M3	10	08-PNS6-12PS	M6	12			
08-PNS3-12PS	M3	12	08-PNS6-16PS	M6	16			
08-PNS3-16PS	M3	16	08-PNS6-20PS	M6	20			
08-PNS3-20PS	M3	20	08-PNS6-25PS	M6	25			
08-PNS3-25PS	M3	25	08-PNS6-30PS	M6	30			
08-PNS3-30PS	M3	30	08-PNS6-40PS	M6	40			
08-PNS3-35PS	M3	35	08-PNS6-50PS	M6	50			
08-PNS3-40PS	M3	40	08-PNS6-75PS	M6	75			
08-PNS3-42PS	M3	42	08-PNS8-16PS	M8	16			
08-PNS4-06PS	M4	6	08-PNS8-20PS	M8	20			
08-PNS4-08PS	M4	8	08-PNS8-30PS	M8	30			
08-PNS4-10PS	M4	10	08-PNS8-50PS	M8	50			



Pan Slot

Material: Nylon 6/6
 * = Available in black
 Thread sizes are in millimetres
 More sizes available

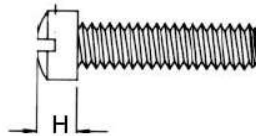
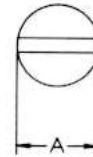

Thread Size	A	H
M2 x 0.4	3.8	1.2
M2.5 x 0.45	4.8	1.4
M3 x 0.5	5.5	1.7
M4 x 0.7	7.7	2.3
M5 x 0.8	9.4	2.8
M6 x 1.0	11.7	3.4
M8 x 1.25	16	4.7
M10 x 1.5	19	6

Nylon Machine Screws - Cheese Slot

Hi-Q Nylon screws are tough, light, durable and corrosion resistant in normal temperatures

Part Number	Thread Size	Thread Length	Part Number	Thread Size	Thread Length
08-PNS2-10CH	M2	10	08-PNS5-20CH	M5	20
08-PNS2-12CH	M2	12	08-PNS5-25CHV	M5	25
08-PNS2-16CH	M2	16	08-PNS5-35CH	M5	35
08-PNS2.5-12CH	M2.5	12	08-PNS5-40CH	M5	40
08-PNS2.5-20CH	M2.5	20	08-PNS6-08CH	M6	8
08-PNS3-06CH*	M3	6	08-PNS6-10CH	M6	10
08-PNS3-08CH	M3	8	08-PNS6-12CH	M6	12
08-PNS3-12CH	M3	12	08-PNS6-16CH	M6	16
08-PNS3-20CH	M3	20	08-PNS6-20CH	M6	20
08-PNS3-25CH	M3	25	08-PNS6-25CH	M6	25
08-PNS4-06CH	M4	6	08-PNS6-35CH	M6	35
08-PNS4-08CH*	M4	8	08-PNS6-40CH	M6	40
08-PNS4-10CH	M4	10	08-PNS6-50CH	M6	50
08-PNS4-12CH	M4	12	08-PNS8-16CH	M8	16
08-PNS4-16CH	M4	16	08-PNS8-20CH	M8	20
08-PNS4-20CH	M4	20	08-PNS8-25CH	M8	25
08-PNS4-25CH	M4	25	08-PNS8-30CH	M8	30
08-PNS5-06CH	M5	6	08-PNS8-35CH	M8	35
08-PNS5-10CH	M5	10	08-PNS10-20CH	M10	20
08-PNS5-12CH	M5	12	08-PNS10-35CH	M10	35
08-PNS5-16CH	M5	16			



Cheese Slot

Material: Nylon 6/6
 * = Available in black
 Thread sizes are in millimetres
 More sizes available

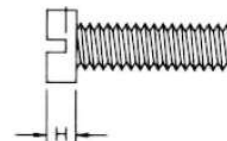

Thread Size	A	H
M2 x 0.4	3.8	1.3
M2.5 x 0.45	4.5	1.6
M3 x 0.5	5.5	2
M4 x 0.7	7	2.6
M5 x 0.8	8.5	3.3
M6 x 1.0	10	3.9
M8 x 1.25	13	5
M10 x 1.5	15.6	6